

STOVES

5435-700

Coleman Electronic Ignition
Propane Camp Stove
Specifications:

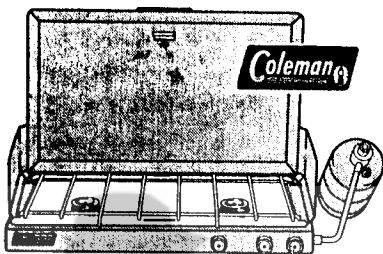

Model 5435-700

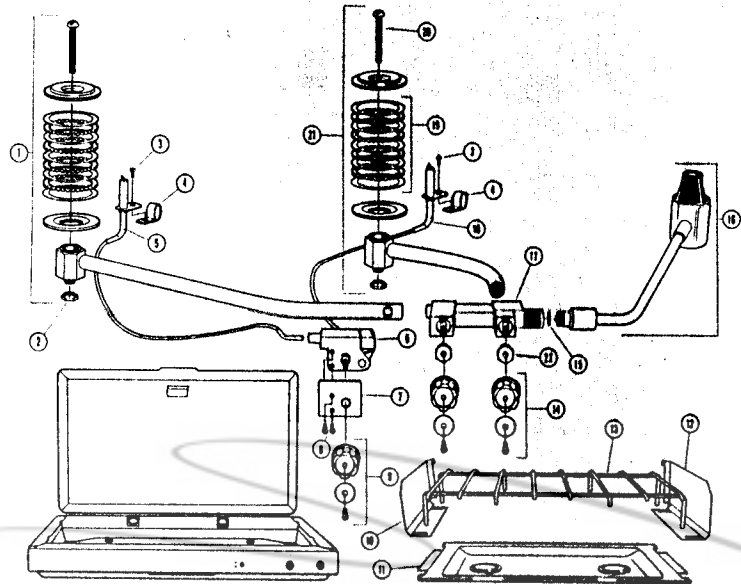

- | | | | | | |
|---|-----------|----------------------|---|-----------|-----------------------|
| ① | 5430-5271 | Burner Assy. LEFT | ⑫ | 5430-3401 | Wind Baffle RIGHT |
| ② | 1201-731 | Nut | ⑬ | 5430-5401 | Grate Assy. |
| ③ | 1147B0604 | Screw x 2 | ⑭ | 5410-5291 | Valve Knob Assy. |
| ④ | 5435-205 | Clamp x 2 | ⑮ | 5410-1341 | O Ring |
| ⑤ | 5435-5801 | Electrode Assy. LEFT | ⑯ | 5430-5541 | Regulator Assy. |
| ⑥ | 5435-5851 | Ignitor Assy. | ⑰ | 5430-5251 | Valve Assy. Complete |
| ⑦ | 5435-1051 | Spacer | ⑱ | 5435-5811 | Electrode Assy. RIGHT |
| ⑧ | 89D0604 | Screw x 2 | ⑲ | 5430-3461 | Burner Ring Set |
| ⑨ | 5430-529 | Ignitor Knob Assy. | ⑳ | 1147B1010 | Screw x 2 |
| ⑩ | 5430-3411 | Wind Baffle LEFT | ㉑ | 5430-5261 | Burner Assy. RIGHT |
| ⑪ | 5435-1501 | Cook Top | ㉒ | 5430-2201 | Valve Nut |